

## DATA SHEET eFlex ACFL Fume hood.

The eFlex ACF family of fume hood is recommended for the handling of hydrofluoric acid and its evacuation in the work area. This prevents dangerous concentrations and deposits in the laboratory. These cabinets also allow the incorporation of a scrubber in the upper part for the dissolution in water of the acids contained in the extraction airflow and their subsequent elimination.

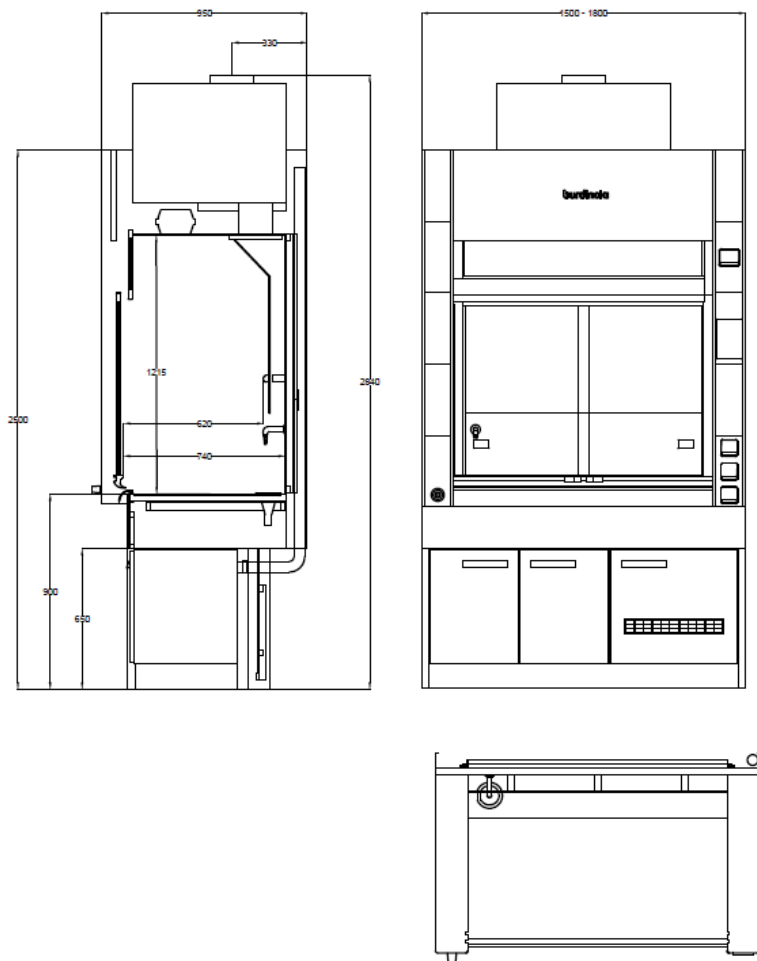



	1500	1800
230V/16A IP54 Power Bases	3	3
Circuit Breaker Protection	1	1
Display Case Control	eFlex touch	eFlex touch
Cold water tap	1	1
Worktop PP Pool	Stoneware 1	Stoneware 1
Luminary	1 pc. 2x55W	1 pc. 2x55W
Extraction output (*)	1xØ250	
Busbar Holder	-	-

N° Guillotines	1	1
No. of sliding glass	2	2

(\*) Output diameters may vary depending on the installation.

Dimensional Data (Tol ±5 mm.)

## Interior Cabin

The interior cabin is made of thermo-welded polypropylene in one piece. This polymer is highly resistant to chemical solvents, bases and acids, making it ideal for applications with any type of acid where there is not a high thermal load.

Polypropylene is an inert product, fully recyclable, its incineration has no polluting effect, and its production technology has the lowest environmental impact.

## Work Surface

The work surface, a structural part of the cabin, is also made of polypropylene, providing excellent performance against chemical attack.

## Structure

Sides made of Fundermax Star Favorit Superfront panels with laminated surface on both sides and flame retardant properties Euroclass B-S1-D0 according to DIN 4102-1.

Interior structure made of tubes obtained from cold-rolled steel sheet (fine carbon steels).

Thermo-hardened powder coating based on epoxy resins (epoxy-polyester)

## Sash window

Sash window made of extruded aluminium profiles, with guides to facilitate the movement of the 6 mm thick glass sheets. (Bilaminar safety glass 3+3 mm).

All aluminium and steel profiles are protected against acids, bases and alkalis, as well as shocks and abrasion, by means of a thermo-hardened powder coating based on epoxy resins (epoxy-polyester powder).

## Concentrated Acid Scrubber

ACFL cabinets allow the installation of a gas scrubber that facilitates the retention of the acid contained in the vapours generated.

The drain of the washer can be connected to the general network, or if you want to be more environmentally friendly, to a tank, which allows the waste to be treated. For this purpose, the installation of a neutralizer is recommended.